

VI.1 NOTE: THIS DEVICE IS ROHS COMPLIANT.

		REVISIONS					
SYM	DESCRIPTION	DATE	APPROVED	SYM	DESCRIPTION	DATE	APPROVED
Δ				Δ			
Δ				Δ			

**\*\*CUSTOMER DRAWING FOR REFERENCE ONLY, SAMPLES APPROVAL ARE REQUIRED!!**

418
-----

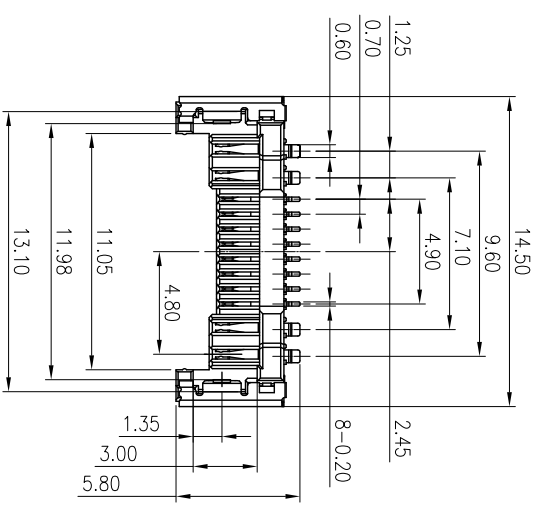
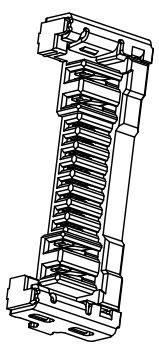

2-8-2 CONNECTOR	
PIN NO.	NAME
1-2	POWER
3-10	SIGNAL
11-12	GND

- SPECIFICATIONS**
1. ELECTRICAL CHARACTERISTICS:  
 1-1. CURRENT RATING: SIGNAL Wire: 0.5A PER PIN (UL10064#32)  
 POWER Wire: 3A (Max.) PER PIN (UL10064#24)
- 1-2. VOLTAGE: 20V AC/DC
- 1-3. I<sub>OCR</sub>: SIGNAL 50mA/POWER 30mA  
 Δ10mD MAX AFTER ENVIRONMENTAL STRESSES
- 1-4. INSULATION RESISTANCE: 100MΩ AT 500V DC
- 1-5. DIELECTRIC WITHSTANDING VOLTAGE: 500V AC FOR 1 MINUTE
2. MECHANIC PERFORMANCE  
 2-1. MATING FORCE : INITIAL 15N~30N AFTER LIFE 6N ~ 25N  
 2-2. UNMATING FORCE : INITIAL 10N TO 30N AFTER LIFE TEST 6N TO 20N  
 2-3. LIFE TEST: 100 CYCLES Min
3. OPERATION TEMPERATURE: -40°C to +85°C
4. CABLE SIDE PROCESS USES FPC OR WIRE SOLDER

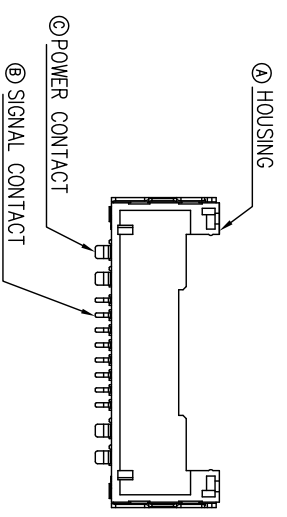
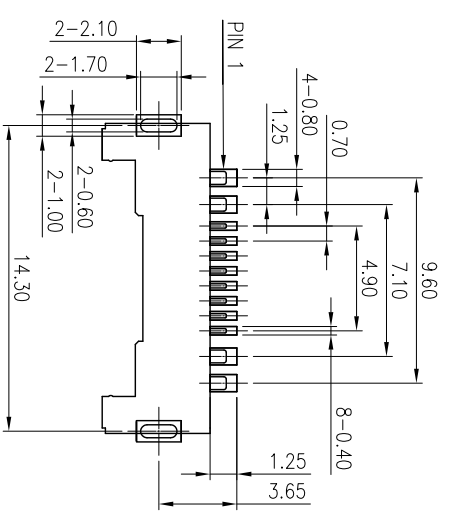
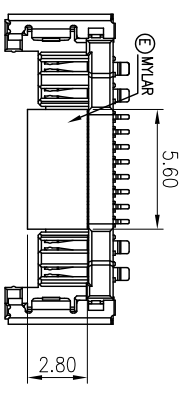
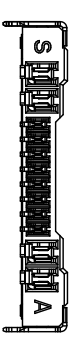
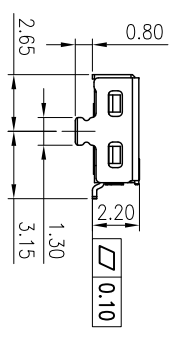
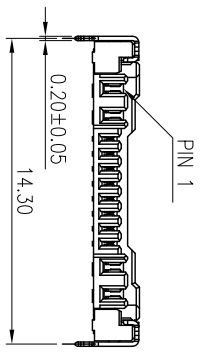

TOLERANCES UNLESS OTHERWISE SPECIFIED		SIGNATURES		DATE		MODEL	
SYMBOL	UNIT	SCALE	CHECKED	DRAWN	19/SEP/25	TITLE	BATTERY WAFER
Δ	mm	3/1	APPROVALS	AARON		NO.	BCCS-0804-2

MMT CORPORATION